

↑**up**Centric®

Height Adjustable 120° Wing-Shape Tables



ergoCentric®

Ergonomic, Stylish, Easy to Adjust and Assemble

The upCentric Electric Height Adjustable 120° Wing-Shape Tables are designed to encourage movement to employees required to sit for extended periods of time; to decrease stress and tension, and to increase productivity and employee satisfaction.

Gyro Sensor - Anti-Collision Solution

All upCentric height adjustable tables include a patented Gyro sensor anti-collision system for enhanced safety and reduced injuries and damage to property.

Pre-settable Memory Positions - One-Touch Adjustment

Moving the table is intuitive with the easy-to-use up/down control and four settable memory positions. Simply press the button with preset position and the table will automatically adjust to your desired position.

Easy to Assemble - Save Your Time

We understand how important easy-assembly is to people looking for height adjustable tables, which is why we've made the upCentric assembly as easy as possible.

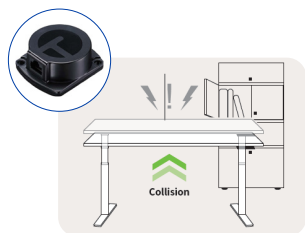

Gyro-Sensor



Pre-settable Memory Positions

Specifications

- Size range:
 - 24" Depth: 36" - 54" width
 - 30" Depth: 36" - 42" width
- Height range: 22.6" - 49"
- Weight capacity: 330 - 350 lbs
- 1" HPL tabletop surface, available in 12 laminate and edge colours
- Frame available in Silver and Black
- Edge corners: standard 90°; optional 1" radius corners available
- Standard placement grommet holes
- Various Power and Wire Management Accessories available
- 3 electric TiMotion® motors
- Sound level: 39dB
- Assembly time: 20 - 30 minutes

Warranty*

- 12 year limited warranty
- 7 year warranty: motors, wires and all electronic components

* Includes parts & labour.

High Pressure Laminate (HPL) Finish



21

Kensington Maple



22

Natural Pear



23

Wild Cherry

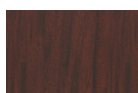

24

Figured Mahogany



26

Asian Night



27

Black

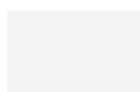

28

Designer White



29

Dove Grey



30

North Sea

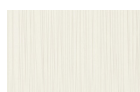

33

Vapor Strandz



34

Studio Teak



35

Walnut Heights

